

YENİ SİTELER MAHALLESİ DÜZENLEME SINIR KROKISI

EK-20

İLİ	ZONGULDAK
İLÇESİ	ALAPLI
MAH/KÖY	YENİ SİTELER
ADA/PARSEL	108/2-3-4



..... tarih sayılı encümen kararı ektir.

	DÜZENLEYEN	UYGUNDUR BELEDİYE / İL ÖZEL İDARE	
		KONTROL EDEN	ONAYLAYAN
ADI SOYADI	AZİMİ NABA		
TARİH	Harita Mühendisi Oda Sicil No: 1135	Neslihan ÇETİN	
İMZA			

PARSELASYON PLANI

İLİ	ZONGULDAK
İLÇESİ	ALAPLI
MAH/KÖY	YENİ SİTELER
ADA/PARSEL	108/2-3-4

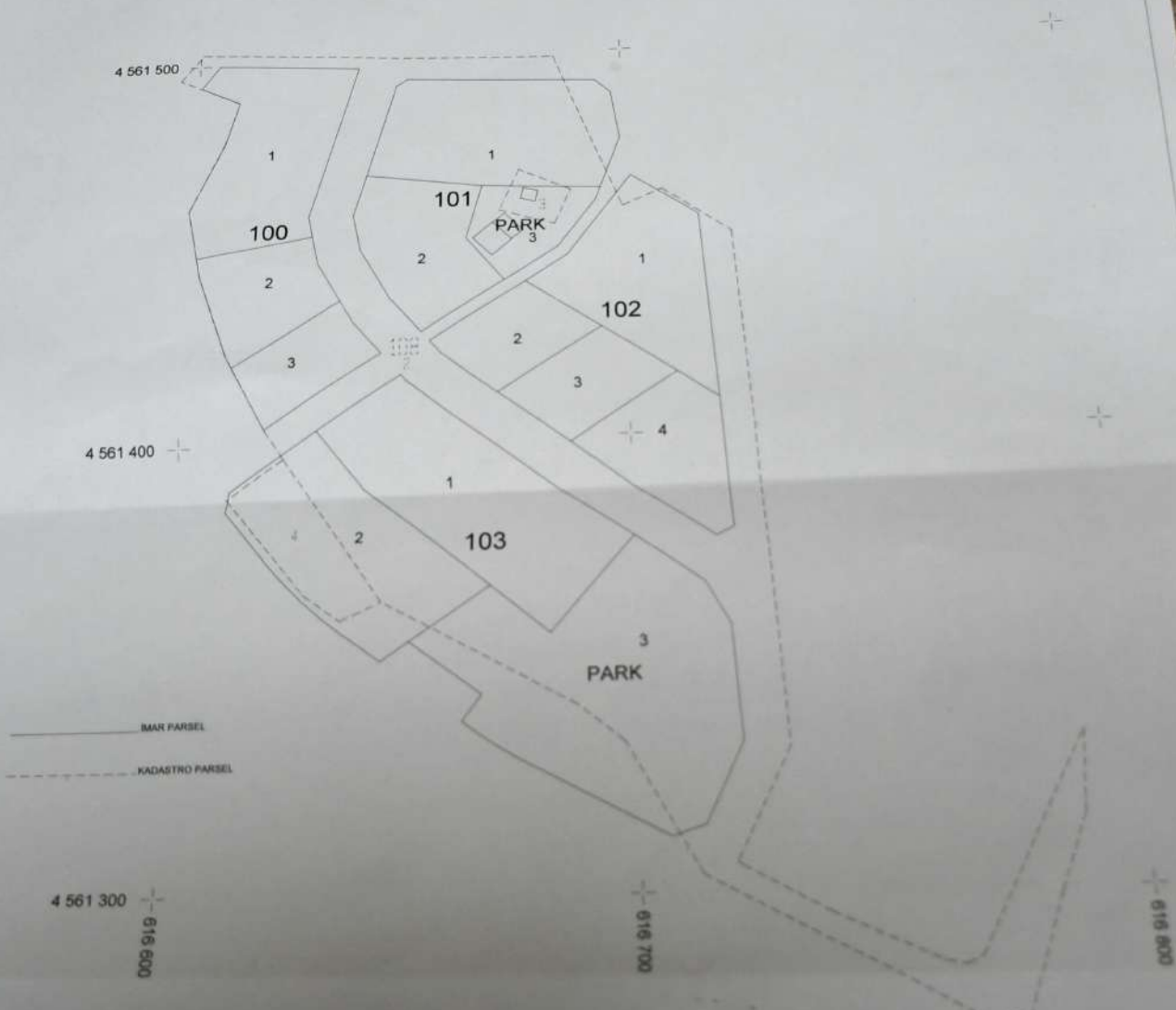

..... tarih sayılı encümen kararı ekidir.

	DÜZENLEYEN	UYGUNDUR BELEDİYE / İL ÖZEL İDARE	
		KONTROL EDEN	ONAYLAYAN
ADI SOYADI	AYDIN NARİN	Neslihan CETİN	
TARİH	09.05.2024		
İMZA			



K A D A S T R O				I M A R							
SNo	Pafta	Ada/Par	Alan	Hisse	Malik/Baba Adı	Kamu	Dop/İTh	Ada/Par	Alan	Hisse	Pay
208	108/3	108/3	142.70	0.04 1/3200	SALIM MEFTUNALTUNÖZ	-	0.03 0.01			3/66848	0.03
209	108/3	108/3	142.70	0.04 1/3200	SALIM MEHSUTALTUNÖZ	-	0.03 0.01			3/66848	0.03
210	108/3	108/3	142.70	0.04 1/3200	SALIM NEŞE ABACI	-	0.03 0.01			3/66848	0.03
211	108/3	108/3	142.70	0.04 1/2560	SALIM SERPİL DIZMEN	-	0.03 0.02			4/66848	0.04
212	108/3	108/3	142.70	0.06 1/2560	EMİN BERGÜZARUZUN	-	0.04 0.02			4/66848	0.04
213	108/3	108/3	142.70	0.06 1/2560	SAİT ŞERİFE ALTUNÖZ	-	0.04 0.02			4/66848	0.04
214	108/3	108/3	142.70	0.06 1/2560	EMİN MUSTAFABOZKURT	-	0.04 0.02			4/66848	0.04
215	108/3	108/3	142.70	0.06 1/192	EMİN SEVİL BASUT	-	0.04 0.33			41/66848	0.41
216	108/3	108/3	142.70	0.74 1/192	MEHMETKAZ MURATYAZGAN	-	0.41 0.33			41/66848	0.41
217	108/3	108/3	142.70	0.74 1/192	NURETTİN MEHMETTEVFIK ELMASA	-	0.41 0.33			41/66848	0.41
218	108/3	108/3	142.70	0.74 11/4096	MEHMET SAD TAHSİN YAZGAN	-	0.41 0.17			21/66848	0.21
219	108/3	108/3	142.70	0.38 11/4096	AYDIN SULTAN AHMET YAZGAN	-	0.21 0.17			21/66848	0.21
220	108/3	108/3	142.70	0.38 1/384	AYDIN F. FISUN PESTİLCİ	-	0.21 0.16			21/66848	0.21
221	108/3	108/3	142.70	0.37 1/384	MUHAMMAD MEHMETKAZIM KÜÇÜKTU	-	0.21 0.16			21/66848	0.21
222	108/3	108/3	142.70	0.37 1/512	MUHAMMAD FATMAYAZGAN	-	0.21 0.12			16/66848	0.16
223	108/3	108/3	142.70	0.28 11/6144	AHMET SAFİYE YAZGAN	-	0.16 0.11			15/66848	0.15
224	108/3	108/3	142.70	0.26 1/640	ALI AYNURBAYAR	-	0.15 0.09			13/66848	0.13
225	108/3	108/3	142.70	0.22 1/640	HALİL SAADET TUTAR	-	0.13 0.09			13/66848	0.13
226	108/3	108/3	142.70	0.22 3/2048	HALİL BAHADIR YAZGAN	-	0.13 0.09			12/66848	0.12
227	108/3	108/3	142.70	0.21 3/2048	REMZİ AHMETNURİ YAZGAN	-	0.12 0.09			12/66848	0.12
228	108/3	108/3	142.70	0.21 1/768	REMZİ YAŞAR KALKAN	-	0.12 0.08			11/66848	0.11
229	108/3	108/3	142.70	0.19 1/768	İSMAİL ÜNSAL ALTINKAYA	-	0.11 0.08			11/66848	0.11
230	108/3	108/3	142.70	0.19 1/768	İSMAİL GÜRSALŞENER	-	0.11 0.08			11/66848	0.11
231	108/3	108/3	142.70	0.19 1/768	İSMAİL MENŞUREYAZGAN	-	0.11 0.08			11/66848	0.11
232	108/3	108/3	142.70	0.19 11/14336	MEHMETRAG NURAYYANIK	-	0.11 0.04			7/66848	0.07
233	108/3	108/3	142.70	0.11 11/14336	TEYYAR TUNCAYKARAYILDIZ	-	0.07 0.04			7/66848	0.07
234	108/3	108/3	142.70	0.11 11/14336	TEYYAR HACERİYÜBOĞLU	-	0.07 0.04			7/66848	0.07
235	108/3	108/3	142.70	0.11 11/14336	TEYYAR YAŞAR YAZGAN	-	0.07 0.04			7/66848	0.07
236	108/3	108/3	142.70	0.11 11/14336	TEYYAR HATİCE KARATAŞ	-	0.07 0.04			7/66848	0.07
237	108/3	108/3	142.70	0.11 11/14336	TEYYAR AHMET YAZGAN	-	0.07 0.04			7/66848	0.07
238	108/3	108/3	142.70	0.11 11/14336	TEYYAR RECEP YAZGAN	-	0.07 0.04			7/66848	0.07
239	108/3	108/3	142.70	0.11 1/1536	TEYYAR SOLMAZ FIRAT	-	0.07 0.05			5/66848	0.05
240	108/3	108/3	142.70	0.09 1/1536	NECDETTİN SÖNMEZÜĞURLU	-	0.05 0.04			5/66848	0.05
241	108/3	108/3	142.70	0.09 1/1536	NECDETTİN MÜNEVVERÖLMEZKAYA	-	0.05 0.04			5/66848	0.05
242	108/3	108/3	142.70	0.09 1/1536	NECDETTİN DİLEK ÖZTÜRK	-	0.05 0.04			5/66848	0.05
243	108/3	108/3	142.70	0.09 1/1536	NECDETTİN HÜLYA SEVİNÇ	-	0.05 0.04			5/66848	0.05
244	108/3	108/3	142.70	0.09 1/1536	NECDETTİN SEVİL ÇITLAK	-	0.05 0.04			5/66848	0.05
245	108/3	108/3	142.70	0.09 1/2048	NECDETTİN HÜSEYİN ŞENER	-	0.05 0.03			4/66848	0.04
246	108/3	108/3	142.70	0.07 1/2048	KÖKSAL HANDEDORUK	-	0.04 0.03			4/66848	0.04
247	108/3	108/3	142.70	0.07 3/8192	KÖKSAL SALIHA KURT YAZGAN	-	0.04 0.02			3/66848	0.03
248	108/3	108/3	142.70	0.05 3/8192	AHMET ECE YAZGAN	-	0.03 0.02			3/66848	0.03
				0.05	HÜDAVERDİ	-	0.03				

NUFİ TEKİN
Belediye Başkanı



AZİZ NABA
Harita Mühendisi
Oda No: 1135

TOPLAMALAN : 19198.89	TESCİLE ESAS	SAYFA NO: 4
TOPLAMPAY : 19198.89	DAĞITIM CETVELİ	TOPLAMADA ALANI : 11263.05
TOPLAMKAMULAŞTIRMA : 0.00	(İMAR PARSELİNE SIRALI)	O.KATILIM ORANI : 0.0000000
TOP. DÜZENLE GİRMEYEN: 0.00		D.O.PAYI ORANI : 0.4499862
TOP. DÜZENLEMİYEN: 19264.25		

K A D A S T R O							İ M A R				
SNo	Pafta	Ada/Par	Alan	Hisse	Malik/Baba Adı	Kamu	Dop/Th	Ada/Par	Alan	Hisse	Pay
249		108/3	142.70	3/8192 0.05	HALİL CAN YAZGAN HÜDAVERDİ	-	0.02 0.03			3/66848	0.03
250		108/3	142.70	3/8192 0.05	ZEYNEP HAZAL YAZGAN HÜDAVERDİ	-	0.02 0.03			3/66848	0.03
251		108/3	142.70	11/6144 0.26	HACERYAZGAN ALİ	-	0.11 0.15			15/66848	0.15
252		108/3	142.70	11/6144 0.26	NURİ SAADET ŞENER REMZİ	-	0.11 0.15			15/66848	0.15
253		108/3	142.70	1/2304 0.06	GÜNAYERKARA HAYRETTİN	-	0.02 0.04			4/66848	0.04
254		108/3	142.70	1/2304 0.06	YALÇIN ÇAKIR HAYRETTİN	-	0.02 0.04			4/66848	0.04
255		108/3	142.70	13/73728 0.03	MERVETAŞKIN SERİN ALEV	-	0.01 0.02			2/66848	0.02
256		108/3	142.70	13/73728 0.03	KIVANÇ TAŞKIN ALEV	-	0.01 0.02			2/66848	0.02
257		108/4	540.77	TAM 540.77	MALİYE HAZİNESİ	-	403.25 492.88	100/3	492.88	TAM	492.88
9		108/2	17032.16	2400/19200 2129.03	ALAPLI BELEDİYESİ	-	958.04 1170.99	101/1	1545.75	117099/154575	1170.99
22		108/2	17032.16	73/1280 971.37	ALAPLI BELEDİYESİ	-	306.61 374.76			37476/154575	374.76
34		108/2	17032.16	329/38400 145.93	HÜSEYİN YAZGAN FAHRETTİN	-	65.67 80.26	101/2	916.43	8026/91643	80.26
35		108/2	17032.16	329/153600 36.48	AYTEN YAZGAN AHMET YAŞA	-	16.42 20.06			2006/91643	20.06
36		108/2	17032.16	329/102400 54.72	FAHRETTİN YAZGAN MEHMETBAK	-	24.63 30.09			3009/91643	30.09
37		108/2	17032.16	329/102400 54.72	HÜSAMETTİNYAZGAN MEHMETBAK	-	24.63 30.09			3009/91643	30.09
38		108/2	17032.16	611/19200 542.01	MURATKARADENİZ İSMAIL	-	243.90 298.11			29811/91643	298.11
39		108/2	17032.16	71/960 1259.67	HACI KURTUL ŞÜKRÜ	-	566.84 692.83			45774/91643	457.74
66		108/2	17032.16	3/1280 39.92	NECMIYE YAZGAN HÜSEYİN	-	17.96 21.96			8/91643	0.08
3		108/2	17032.16	470/19200 416.94	HÜSEYİN YAZGAN FAHRETTİN	-	187.62 229.32	102/1	1223.51	492/122351	4.92
14		108/2	17032.16	3285/307200 182.13	MUSTAFAYAZGAN KAMİL	-	81.96 100.17			10017/122351	100.17
15		108/2	17032.16	3285/307200 182.13	MERALDOĞAN KAMİL	-	81.96 100.17			10017/122351	100.17
16		108/2	17032.16	3285/307200 182.13	BAHARYILMAZ KAMİL	-	81.96 100.17			10017/122351	100.17
17		108/2	17032.16	3285/307200 182.13	SELDA TOPAL KAMİL	-	81.96 100.17			10017/122351	100.17
18		108/2	17032.16	4380/307200 242.84	MÜNEVVER YAZGAN MEHMET	-	109.28 133.56			13356/122351	133.56
39		108/2	17032.16	71/960 1259.67	HACI KURTUL ŞÜKRÜ	-	566.84 692.83			22574/122351	225.74
40		108/2	17032.16	47/4800 166.77	ŞAZIYE YAZGAN ŞERAFETTİN	-	75.05 91.72			9172/122351	91.72
41		108/2	17032.16	47/4800 166.77	ADVIYE YAVUZ ŞERAFETTİN	-	75.05 91.72			9172/122351	91.72
42		108/2	17032.16	47/4800 166.77	MEC BURBAKARTUNA ŞERAFETTİN	-	75.05 91.72			9172/122351	91.72
43		108/2	17032.16	47/2400 333.55	NACIYE BODUR ŞERAFETTİN	-	150.10 183.45			18345/122351	183.45
53		108/2	17032.16	73/5120 242.84	BAKİ YAZGAN HALİT	-	109.27 133.57	102/2	534.31	13357/53431	133.57
54		108/2	17032.16	73/5120 242.84	HÜSEYİN YAZGAN HALİT	-	109.27 133.57			13357/53431	133.57
55		108/2	17032.16	73/5120 242.84	SEVİM ACAR HALİT	-	109.27 133.57			13357/53431	133.57
56		108/2	17032.16	73/20480 60.71	MÜNEVVER YAZGAN MEHMET	-	27.31 33.40			3340/53431	33.40
57		108/2	17032.16	219/81920 45.53	MERALDOĞAN KAMİL	-	20.48 25.05			2505/53431	25.05
58		108/2	17032.16	219/81920 45.53	SELDA TOPAL KAMİL	-	20.48 25.05			2505/53431	25.05
59		108/2	17032.16	219/81920 45.53	MUSTAFAYAZGAN KAMİL	-	20.48 25.05			2505/53431	25.05
60		108/2	17032.16	219/81920 45.53	BAHAR YILMAZ KAMİL	-	20.48 25.05			2505/53431	25.05
11		108/2	17032.16	219/19200 194.28	CEMAL YAZGAN HÜSEYİN	-	87.43 106.85	102/3	534.25	10685/53425	106.85
12		108/2	17032.16	219/19200	CEVDET YAZGAN	-	87.43			10685/53425	106.85

Nuri TEKİN
Belediye Başkanı



Azm. M. S. B. A.
Harita Müdürlüğü
Oda No: 1135

TOPLAMALAN : 19198.89	T E S C İ L E E S A S D A Ğ İ T İ M C E T V E L İ (İ M A R P A R S E L İ N E S İ R A L I)	SAYFA NO : 5
TOPLAMPAY : 19198.89		TOPLAMADA ALANI : 11263.05
TOPLAMKAMULAŞTIRMA : 0.00		O.KATILIM ORANI : 0.0000000
TOP. DÜZENLE GİRMEYEN : 0.00		D.O.PAYI ORANI : 0.449862
TOP. DÜZENLEMİYEN : 19264.25		

K A D A S T R O							I M A R				
SNo	Pafta	Ada/Par	Alan	Hisse	Malik/Baba Adı	Kamu	Dop/Th	Ada/Par	Alan	Hisse	Pay
13		108/2	17032.16	194.27 657/19200 582.82	HÜSEYİN HÜSEYİN YAZGAN HALİT	-	106.85 262.27 320.55			32055/53425	320.55
1		108/2	17032.16	160/19200 141.94	MEHMET FATMA	-	63.88 78.06	102/4	730.59	7806/73059	78.06
2		108/2	17032.16	160/19200 141.94	İZZET FATMA	-	63.88 78.06			7806/73059	78.06
6		108/2	17032.16	160/19200 141.94	ŞÜKRÜ HALİT	-	63.88 78.06			7806/73059	78.06
28		108/2	17032.16	109/3840 483.46	OSMAN İKOĞLU MEHMETADN	-	217.56 265.90			18859/73059	188.59
46		108/2	17032.16	1/180 106.45	DURKADIN YAZGAN İLYAS	-	47.91 58.54			5854/73059	58.54
47		108/2	17032.16	3/640 79.84	ŞÜKRÜ YAZGAN CAVİT	-	35.93 43.91			4391/73059	43.91
48		108/2	17032.16	3/640 79.84	MURAT YAZGAN CAVİT	-	35.93 43.91			4391/73059	43.91
49		108/2	17032.16	3/640 79.84	ÖZEN YAZGAN CAVİT	-	35.93 43.91			4391/73059	43.91
50		108/2	17032.16	3/640 79.84	ÖZLEMDEMİR CAVİT	-	35.92 43.92			4392/73059	43.92
66		108/2	17032.16	3/1280 39.92	NECMIYE YAZGAN HÜSEYİN	-	17.96 21.96			225/73059	2.25
117		108/3	142.70	60/3840 2.24	İSMET YAZGAN MEHMETNEC	-	1.01 1.23			123/73059	1.23
118		108/3	142.70	72/3840 2.68	NAZIKAR YAZGAN HALİL	-	1.21 1.47			147/73059	1.47
119		108/3	142.70	72/3840 2.68	MEHMETNECATI YAZGAN MEHMETİZZ	-	1.21 1.47			147/73059	1.47
120		108/3	142.70	216/3840 8.03	AHMETAVNI YAZGAN MEHMETİZZ	-	3.62 4.41			441/73059	4.41
121		108/3	142.70	876/3840 32.55	HALİT YAZGAN ALİ RIZA	-	14.65 17.90			1790/73059	17.90
122		108/3	142.70	96/3840 3.57	AHMETNURİ YAZGAN EYÜP	-	1.61 1.96			196/73059	1.96
123		108/3	142.70	96/3840 3.57	MÜNEWERYAZGAN MEHMET	-	1.61 1.96			196/73059	1.96
124		108/3	142.70	96/3840 3.57	MUSTAFAKAYA HÜSEYİN	-	1.61 1.96			196/73059	1.96
125		108/3	142.70	96/3840 3.57	SARIYE EYÜP	-	1.61 1.96			196/73059	1.96
126		108/3	142.70	32/3840 1.19	MEHMET FATMA	-	0.54 0.65			65/73059	0.65
127		108/3	142.70	32/3840 1.19	İZZET FATMA	-	0.54 0.65			65/73059	0.65
128		108/3	142.70	94/3840 3.49	HÜSEYİN YAZGAN FAHRETTİN	-	1.58 1.91			191/73059	1.91
129		108/3	142.70	109/3840 4.05	BEHİCE KAYAALP MUSTAFA	-	1.83 2.22			222/73059	2.22
130		108/3	142.70	109/3840 4.05	MUSTAFABOZMA MUSTAFA	-	1.83 2.22			222/73059	2.22
131		108/3	142.70	32/3840 1.19	ŞÜKRÜ HALİT	-	0.54 0.65			65/73059	0.65
132		108/3	142.70	109/15360 1.01	EMİNE NİRAN BOZMA İBRAHİM RE	-	0.46 0.55			55/73059	0.55
133		108/3	142.70	109/10240 1.52	NİLGÜN ŞAHİN MEHMETTÜR	-	0.69 0.83			83/73059	0.83
134		108/3	142.70	109/10240 1.52	BERRİN TOSUN MEHMETTÜR	-	0.69 0.83			83/73059	0.83
135		108/3	142.70	47/4800 1.40	SAFİYE YAZGAN ŞERAFETTİN	-	0.63 0.77			77/73059	0.77
136		108/3	142.70	47/4800 1.40	ADVIYE YAVUZ ŞERAFETTİN	-	0.63 0.77			77/73059	0.77
137		108/3	142.70	47/4800 1.40	NECMIYE BAŞMADEN ŞERAFETTİN	-	0.63 0.77			77/73059	0.77
138		108/3	142.70	47/4800 1.40	MECBUREAKARTUNA ŞERAFETTİN	-	0.63 0.77			77/73059	0.77
139		108/3	142.70	47/4800 1.40	NACİYE BODUR ŞERAFETTİN	-	0.63 0.77			77/73059	0.77
140		108/3	142.70	1/256	ŞAZİYE YAZGAN	-	0.26			30/73059	0.30

Nuri Tekin
NURİ TEKİN
Belediye Başkanı



AZİM NİSA
Harita Müdürlüğü
Oda No: 1135

TOPLAMALAN : 19198.89	TESCİLE ESAS	SAYFA NO: 6
TOPLAMPAY : 19198.89	DAĞITIM CETVELİ	TOPLAMADA ALANI : 11263.05
TOPLAMKAMULAŞTIRMA : 0.00	(İMAR PARSELİNE SIRALI)	O.KATILIM ORANI : 0.0000000
TOP. DÜZENLE. GİRMEYEN: 0.00		D.O.PAYI ORANI : 0.4499862
TOP. DÜZENLEMİYEN: 19264.25		

K A D A S T R O							İ M A R				
SNc	Pafta	Ada/Par	Alan	Hisse	Malik/Baba Adı	Kamu	Dop/Th	Ada/Par	Alan	Hisse	Pay
141	108/3	108/3	142.70	0.56 1/256	ŞERAFETTİN CEMAL YAZGAN	-	0.30 0.26			30/73059	0.30
142	108/3	108/3	142.70	0.56 1/256	HİKMET PERVİM EMRE	-	0.30 0.26			30/73059	0.30
143	108/3	108/3	142.70	0.56 1/256	HİKMET NECATİ YAZGAN	-	0.30 0.26			30/73059	0.30
144	108/3	108/3	142.70	0.87 47/7680	AHMET YAŞA AYTEN YAZGAN	-	0.47 0.40			47/73059	0.47
145	108/3	108/3	142.70	1.31 47/5120	FAHRETTİN YAZGAN MEHMETBAK	-	0.59 0.72			72/73059	0.72
146	108/3	108/3	142.70	1.31 47/5120	HÜSAMETTİN YAZGAN MEHMETBAK	-	0.59 0.72			72/73059	0.72
147	108/3	108/3	142.70	4.05 109/3840	OSMANLIKOĞLU MEHMETADN	-	1.83 2.22			222/73059	2.22
148	108/3	108/3	142.70	1/40 3.57	NERİMAN ÖZKAN ŞÜKRÜ	-	1.61 1.96			196/73059	1.96
149	108/3	108/3	142.70	1/40 3.57	NURAYILMAZ HÜSEYİN KE	-	1.61 1.96			196/73059	1.96
150	108/3	108/3	142.70	1/40 3.57	LÜTFİYE ARSLAN ŞÜKRÜ	-	1.61 1.96			196/73059	1.96
151	108/3	108/3	142.70	1/160 0.89	DURKADIN YAZGAN İLYAS	-	0.41 0.48			48/73059	0.48
152	108/3	108/3	142.70	3/640 0.67	ÖZLEMDEMİR CAVİT	-	0.31 0.36			36/73059	0.36
153	108/3	108/3	142.70	3/640 0.67	ŞÜKRÜ YAZGAN CAVİT	-	0.31 0.36			36/73059	0.36
154	108/3	108/3	142.70	3/640 0.67	MURAT YAZGAN CAVİT	-	0.31 0.36			36/73059	0.36
155	108/3	108/3	142.70	3/640 0.67	ÖZEN YAZGAN CAVİT	-	0.31 0.36			36/73059	0.36
156	108/3	108/3	142.70	1/40 3.57	CEMİLE ŞAYIGAN YAŞAR MEHMETBUR	-	1.61 1.96			196/73059	1.96
157	108/3	108/3	142.70	0.82 47/8192	AYŞE AÇIKALIN HACIAL MEHMETALİ	-	0.37 0.45			45/73059	0.45
158	108/3	108/3	142.70	0.87 47/7680	CEMAL CEMPEHLIVAN HÜSEYİN Fİ	-	0.40 0.47			47/73059	0.47
159	108/3	108/3	142.70	0.87 47/7680	NAZMIYE NUR PEHLIVAN HÜSEYİN Fİ	-	0.40 0.47			47/73059	0.47
160	108/3	108/3	142.70	0.20 47/32768	CEYDA AÇIKALIN HAKKI	-	0.09 0.11			11/73059	0.11
161	108/3	108/3	142.70	0.31 141/65536	MEHMETALİ AÇIKALIN MUSTAFATE	-	0.14 0.17			17/73059	0.17
162	108/3	108/3	142.70	0.31 141/65536	ALP AÇIKALIN MUSTAFATE	-	0.14 0.17			17/73059	0.17
163	108/3	108/3	142.70	0.11 47/61440	GÖNÜLNEŞE GÜNDÜZ DURMUŞKAY	-	0.05 0.06			6/73059	0.06
164	108/3	108/3	142.70	0.58 47/11520	İBRAHİM AHMETBAYRI HÜSEYİN NE	-	0.27 0.31			31/73059	0.31
165	108/3	108/3	142.70	0.58 47/11520	SİDİKA İPEK ATAY HÜSEYİN NE	-	0.27 0.31			31/73059	0.31
166	108/3	108/3	142.70	0.58 47/11520	HATİCE DİLEK GÜRGÜR HÜSEYİN NE	-	0.27 0.31			31/73059	0.31
167	108/3	108/3	142.70	1.75 47/3940	NAZMIYE GAMZEPEHLIV FARUK	-	0.79 0.96			96/73059	0.96
168	108/3	108/3	142.70	0.61 329/76800	GÜLÇİN ARAÇ ATA	-	0.28 0.33			33/73059	0.33
169	108/3	108/3	142.70	0.61 329/76800	YUSUF ÇUHAN ATA	-	0.28 0.33			33/73059	0.33
170	108/3	108/3	142.70	1.22 329/38400	YAŞAR GÖKALP FAHRETTİN	-	0.55 0.67			67/73059	0.67
171	108/3	108/3	142.70	1.22 329/38400	HÜSEYİN YAZGAN FAHRETTİN	-	0.55 0.67			67/73059	0.67
172	108/3	108/3	142.70	0.22 47/30720	BİLLUR BİRNÜR YÜZ İSMAIL	-	0.10 0.12			12/73059	0.12
173	108/3	108/3	142.70	0.22 47/30720	MURATKARADENİZ İSMAIL	-	0.10 0.12			12/73059	0.12
174	108/3	108/3	142.70	0.22 47/30720	BİRGÜL ERKARA İSMAIL	-	0.10 0.12			12/73059	0.12
175	108/3	108/3	142.70	0.22 47/30720	BİNAY GAZİTEPE İSMAIL	-	0.10 0.12			12/73059	0.12
176	108/3	108/3	142.70	0.31 329/153600	MUSTAFAMERKAN İSMAIL	-	0.14 0.17			17/73059	0.17
177	108/3	108/3	142.70	0.46 329/102400	HAKAN MERKAN MUSTAFA	-	0.21 0.25			25/73059	0.25
178	108/3	108/3	142.70	0.46 329/102400	SERKENMERKAN MUSTAFA	-	0.21 0.25			25/73059	0.25
179	108/3	108/3	142.70	0.31 329/153600	AYTEN YAZGAN AHMET YAŞA	-	0.14 0.17			17/73059	0.17
180	108/3	108/3	142.70	0.46 329/102400	FAHRETTİN YAZGAN MEHMETBAK	-	0.21 0.25			25/73059	0.25
181	108/3	108/3	142.70	0.46 329/102400	HÜSAMETTİN YAZGAN MEHMETBAK	-	0.21 0.25			25/73059	0.25

Nuri TEKİN
Belediye Başkanı



AZM KABA
Harita Müdürlüğü
Oda No: 1135

TOPLAMALAN : 19198.89	TESCİLE ESAS	SAYFA NO: 7
TOPLAMPAY : 19198.89	DAĞITIM CETVELİ	TOPLAMADA ALANI : 11263.05
TOPLAMKAMULAŞTIRMA : 0.00	(İMAR PARSELİNE SIRALI)	O.KATILIM ORANI : 0.0000000
TOP. DÜZENLE GİRMEYEN: 0.00		D.O.PAYI ORANI : 0.4499862
TOP. DÜZENLEMİYEN: 19264.25		

K A D A S T R O							İ M A R					
SNo	Pafta	Ada/Par	Alan	Hisse	Melik/Baba Adı	Kamu	Dop/İTh	Ada/Par	Alan	Hisse	Pay	
4		108/2	17032.16	545/19200	BEHİCE KAYAALP	-	217.56	103/1	1733.76	26591/173376	265.91	
5		108/2	17032.16	483.47	MUSTAFA	-	265.91			26591/173376	265.91	
7		108/2	17032.16	545/19200	MUSTAFABOZMA	-	217.56			26591/173376	265.91	
8		108/2	17032.16	483.47	MUSTAFA	-	265.91			7806/173376	78.06	
10		108/2	17032.16	160/19200	SAMİME ŞENER	-	63.88			7806/173376	78.06	
19		108/2	17032.16	141.94	HÜSEYİN	-	78.06			23420/173376	234.20	
20		108/2	17032.16	160/19200	MURATYAZGAN	-	63.88			6648/173376	66.48	
21		108/2	17032.16	141.94	NURETTİN	-	78.06			9971/173376	99.71	
26		108/2	17032.16	480/19200	YILMAZ ÖZCAN	-	191.61			9971/173376	99.71	
61		108/2	17032.16	425.81	SABRİ	-	234.20			7731/173376	77.31	
62		108/2	17032.16	109/15360	EMİNE NIRAN BOZMA	-	54.39			8783/173376	87.83	
63		108/2	17032.16	120.87	İBRAHİM RE	-	66.48			11710/173376	117.10	
64		108/2	17032.16	109/10240	NİLGÜN ŞAHİN	-	81.59			8783/173376	87.83	
65		108/2	17032.16	181.30	MEHMETTÜR	-	99.71			2196/173376	21.96	
66		108/2	17032.16	109/10240	BERRİN TOSUN	-	81.59			2196/173376	21.96	
67		108/2	17032.16	181.30	MEHMETTÜR	-	99.71			650/173376	6.50	
68		108/2	17032.16	109/3840	OSMANLIKOĞLU	-	217.56			3294/173376	32.94	
69		108/2	17032.16	483.46	MEHMETADN	-	265.90			3294/173376	32.94	
70		108/2	17032.16	3/320	BAHADIR YAZGAN	-	71.85			4392/173376	43.92	
71		108/2	17032.16	159.68	REMZİ	-	87.83			293/173376	2.93	
72		108/2	17032.16	1/80	FATMA YAZGAN	-	95.80			293/173376	2.93	
73		108/2	17032.16	212.90	AHMET	-	117.10			293/173376	2.93	
74		108/2	17032.16	3/320	NURİ SAADETŞENER	-	71.85			293/173376	2.93	
75		108/2	17032.16	159.68	REMZİ	-	87.83			293/173376	2.93	
76		108/2	17032.16	3/1280	HALİL CAN YAZGAN	-	17.96			147/173376	1.47	
77		108/2	17032.16	39.92	HÜDEVERDİ	-	21.96			147/173376	1.47	
78		108/2	17032.16	3/1280	ZEYNEP HAZAL YAZGAN	-	17.96			77/173376	0.77	
79		108/2	17032.16	39.92	HÜDAVERDİ	-	21.96					
80		108/2	17032.16	3/1290	NECMİYE YAZGAN	-	17.96					
81		108/2	17032.16	39.92	HÜSEYİN	-	21.96					
82		108/2	17032.16	9/2560	REMZİ YAZGAN	-	26.94					
83		108/2	17032.16	59.88	AHMETNURİ	-	32.94					
84		108/2	17032.16	9/2560	YASEMİN YAZGAN	-	26.94					
85		108/2	17032.16	59.88	AHMETNURİ	-	32.94					
86		108/2	17032.16	3/640	SALİHA KURT YAZGAN	-	35.92					
87		108/2	17032.16	79.84	AHMET	-	43.92					
88		108/2	17032.16	1/3200	SEVİM ÇOLAK	-	2.39					
89		108/2	17032.16	5.32	NİYAZI	-	2.93					
90		108/2	17032.16	1/3200	ALİ ÇOLAK	-	2.39					
91		108/2	17032.16	5.32	NİYAZI	-	2.93					
92		108/2	17032.16	1/3200	SELİM ÇOLAK	-	2.39					
93		108/2	17032.16	5.32	KEMAL	-	2.93					
94		108/2	17032.16	1/3200	NEVİM KAYNAK	-	2.39					
95		108/2	17032.16	5.32	NİYAZI	-	2.93					
96		108/2	17032.16	1/6400	FURKANÇOLAK	-	1.19					
97		108/2	17032.16	2.66	MUSTAFA	-	1.47					
98		108/2	17032.16	1/6400	TARİK ÇOLAK	-	1.19					
99		108/2	17032.16	2.66	MUSTAFA	-	1.47					
100		108/2	17032.16	1/12288	ALEV TAŞKIN	-	0.62					
101		108/2	17032.16	1.39	MUSTAFAFE	-	0.77					
258		0/9999	1483.26	TAM	MALİYE HAZİNESİ	-	0.00	103/2	1483.26	TAM	1483.26	
				1483.26			1483.26					

AZMI NABA HARİTA MÜHENDİSLİK BÜROSU

KURU TEKİN
Belediye Başkanı



Azmi NABA
Harita Mühendisi
Oda Sicil No: 135